



**£2,200 pcm**  
2 bedroom flat

Devonshire Road  
London

# Read all about it...

Located on the raised ground floor of a stunning Victorian block is this spacious and beautifully presented furnished 2-bedroom flat, available to rent immediately. Perfectly positioned between Forest Hill and Honor Oak Park, residents enjoy convenient access to both town centres, offering a wide range of independent shops, green spaces, transport links, pubs, and restaurants.

Internally, the flat spans over 80 sqm of well-proportioned living space. A welcoming hallway leads into a generous lounge, which flows seamlessly into a contemporary kitchen. At the front of the property are two large double bedrooms, both with built-in wardrobes—the principal bedroom also benefits from a private en-suite shower room.

Externally, the property offers access to a well-maintained communal garden at the rear, as well as a communal bike shed (available for a small charge).

Available Now | Furnished | Council Tax: Lewisham Band C

## RAISED GROUND FLOOR

### Hallway

Pendant ceiling light, laminate flooring.

### Lounge

4.46m x 3.93m (14' 8" x 12' 11")  
Spotlights, sash window, double glazed frosted glass window, free standing shelves, wall mounted TV and speaker, lamps, corner sofa, coffee table, radiator, fitted carpet.

### Kitchen

3.54m x 3.07m (11' 7" x 10' 1")  
Spotlights, sash window, fitted kitchen units, stainless steel sink with drainer, gas hob, electric oven, dishwasher, washing machine, dining table, fridge, freezer, tiled flooring.

### Bedroom

4.79m x 4.18m (15' 9" x 13' 9")  
Spotlights, sash windows, curtains, built-in wardrobe, bed and mattress mirror, radiators, dressing table, fitted carpet.

### Ensuite

Spotlights, tiled wall, walk-in shower, heated towel rail, mirror, washbasin, WC, tiled flooring.

### Bedroom

4.65m x 3.35m (15' 3" x 11' 0")  
Spotlights, sash windows, curtains, built-in wardrobe, free-standing drawers, bed and mattress, radiator, fitted carpet.

### Bathroom

1.93m x 1.70m (6' 4" x 5' 7")  
Spotlights, tiled wall, shower bath, heated towel rail, washbasin, WC, tiled flooring.

## OUTSIDE

### Communal Garden

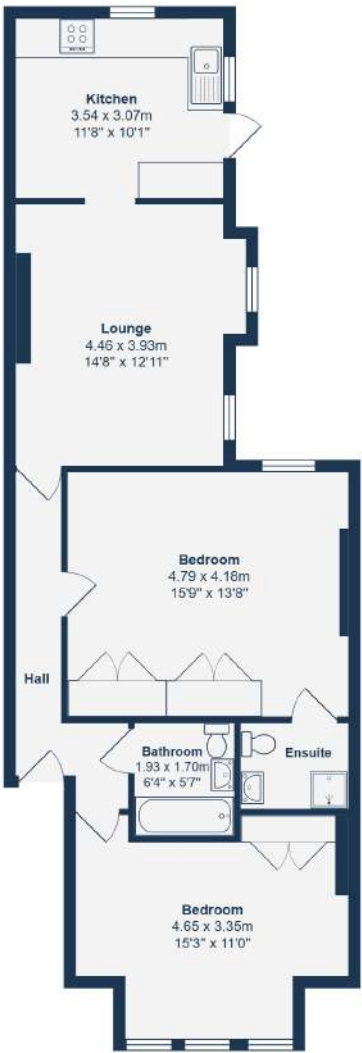

Ground Floor

Total Area: 76.5 m² ... 823 ft²

Drawn for Stanfords Sales & Lettings

This floorplan is for illustrative purposes only. Whilst every effort has been made to ensure the accuracy of the plan, the dimensions and total area are approximated only and should not be relied upon.

Like what you see?

Call 020 8699 6778 or email us at [foresthill@stanfordestates.london](mailto:foresthill@stanfordestates.london) to arrange a viewing or request further information

[www.stanfordestates.london](http://www.stanfordestates.london)





TWO DOUBLE  
BEDROOMS  
COMMUNAL GARDEN  
GROUND FLOOR

TWO BATHROOMS  
FURNISHED  
AVAILABLE NOW





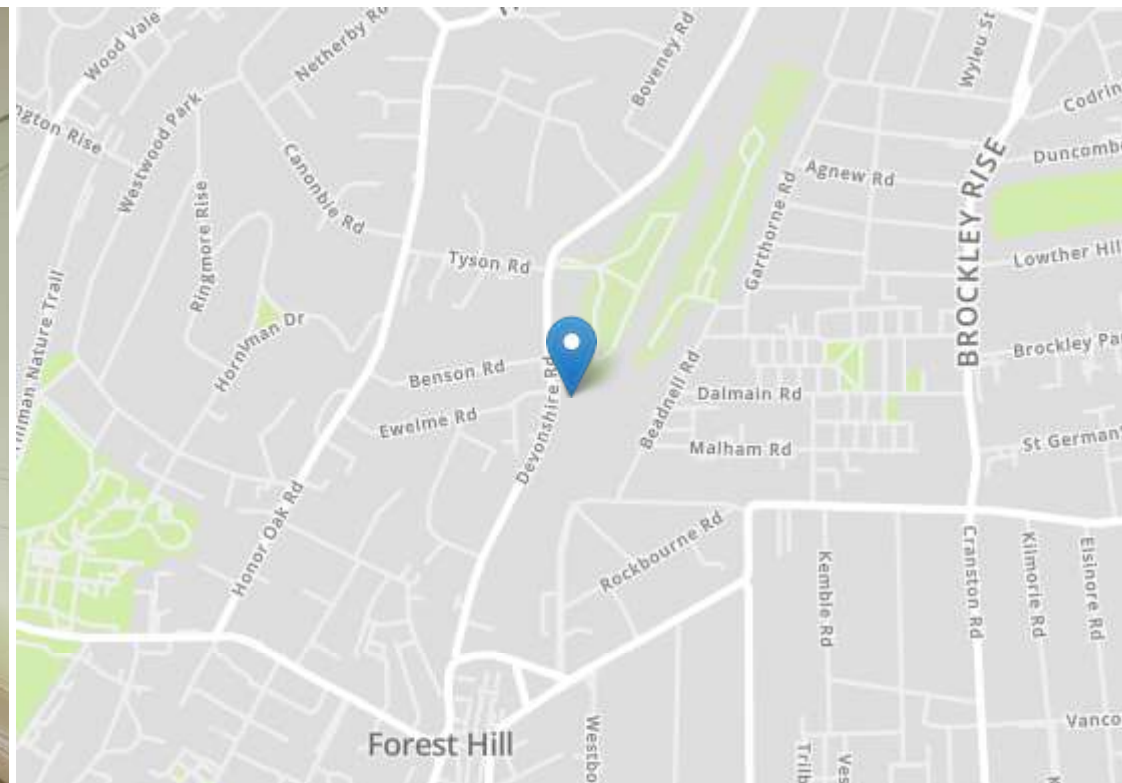

Robert Stanford Estates property particulars are produced in accordance with the Consumer Rights Act (2015) and should not be construed as a contract or offer. The contents of these property particulars are to provide a general illustration only and are inconsequential to any decisions to purchase a property. A potential buyer accepts that all representations made by these particulars are made in good faith on behalf of the seller and require verification by a buyers' legal and professional representatives prior to an exchange of contracts. We offer no guarantees for any structural component, service or appliance and while we make every effort to take accurate measurements and distances, they are illustrative only. Any reliance you place on information within these particulars is therefore strictly at your own risk.