



STANFORDS

Chiltonian Mews, London

Guide Price £385,000

Situated on the second floor within the development, this well-presented two-bedroom flat offers bright, modern living just moments from Hither Green Station — ideal for commuters.

The property boasts a spacious open-plan lounge/diner with a semi open-plan kitchen, creating a sociable and versatile living space. The layout allows for a natural flow between cooking, dining, and relaxing areas, making it perfect for both everyday living and entertaining. Large windows flood the room with natural light, enhancing the sense of space and warmth throughout.

Both bedrooms are well-proportioned and offer comfortable accommodation, with flexibility for additional storage or home working if required. The flat is well suited to first-time buyers, professionals, or investors seeking a conveniently located property.

Perfectly positioned, right next to the station and within easy reach of local shops, cafes, and green spaces, this property combines comfort with exceptional connectivity.

Council Tax band: C

Tenure: Leasehold

EPC Energy Efficiency Rating: C

EPC Environmental Impact Rating:

- **Two Bedrooms**
- **Open Plan Lounge/Diner**
- **Less Than 0.1mi to Hither Green Station**
- **Total Area - 663sqft**







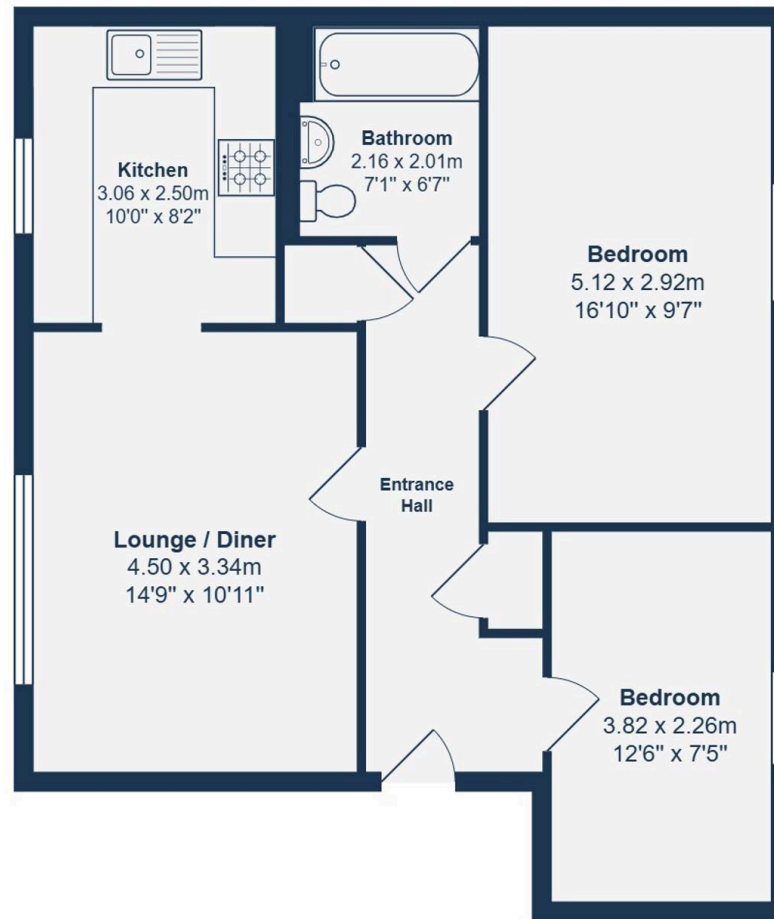

Second Floor

Total Area: 61.6 m² ... 663 ft²

Drawn for Stanfords Sales & Lettings

This floorplan is for illustrative purposes only. Whilst every effort has been made to ensure the accuracy of the plan, the dimensions and total area are approximated only and should not be relied upon.



SECOND FLOOR

Lounge/Diner

14' 9" x 10' 11" (4.50m x 3.34m)

Pendant lights, large windows, radiator, wood floor.

Kitchen

10' 0" x 8' 2" (3.06m x 2.50m)

Pendant light, window, matching base and wall cupboards, sink basin with mixer tap, plumbing for washing machine, integrated oven and hob, wood floor.

Bathroom

7' 1" x 6' 7" (2.16m x 2.01m)

Ceiling lights, tiled wall and splash back, bath tub with mixer taps and shower head, sink, toilet, wall-mounted heated towel rail, tile floor.

Bedroom

16' 10" x 9' 7" (5.12m x 2.92m)

Pendant light, window, radiators, carpet.

Bedroom

12' 6" x 7' 5" (3.82m x 2.26m)

Pendant light, window, radiator, carpet.



You can include any text here. The text can be modified upon generating your brochure.

STANFORDS